

GET READY TO RISE

PULLMAN PARIS MONTPARNASSE PRESENTATION



pullman
HOTELS AND RESORTS

PARIS MONTPARNASSE

PULLMAN PARIS MONTPARNASSE



4 YEARS OF TRANSFORMATION
957 GUESTROOMS
5 RESTAURANTS & BARS

SUMMARY

HOME

DESTINATION
MONTPARNASSE

WELCOME

EAT

SLEEP

MEET

PLAY

DREAM

CONTACT



PARIS MONTPARNASSE

DESTINATION

PARIS A TIMELESS DESTINATION

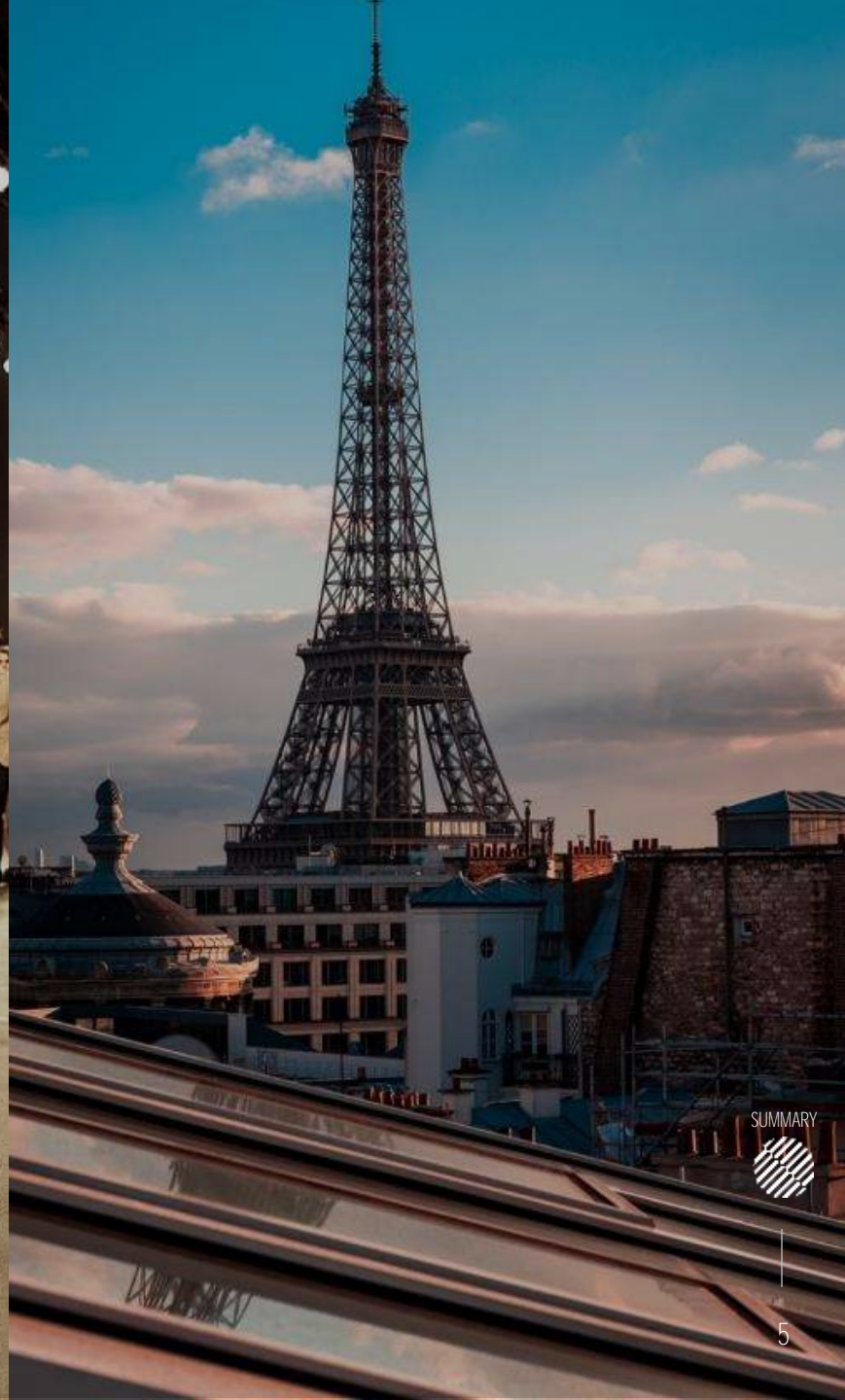

AN IDEAL LOCATION

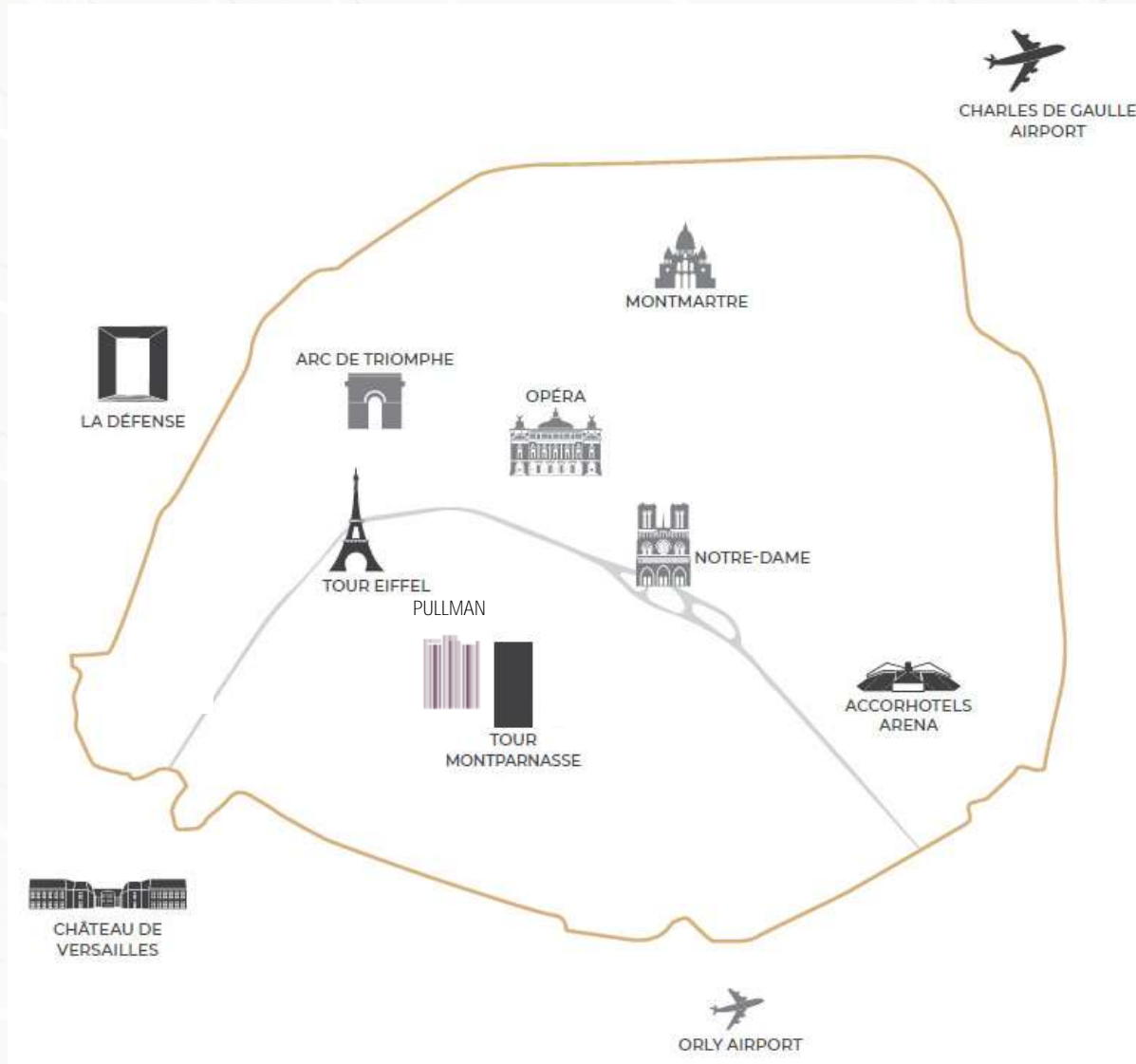

Access to the hotel :



Orly: 20 min

Roissy CDG: 45 min



Montparnasse Train Station: 100 m



Metro lines 4, 6, 12, 13 & Bus lines: 2 min



A perfect location to explore Paris' streets, visit iconic monuments, enjoy a coffee in Saint-Germain-des-Près or shop at Le Bon Marché.



PARIS MONTPARNASSE DESTINATION

CULTURAL | COSMOPOLITAN

In the heart of Paris, Montparnasse district is the perfect mix between tradition and modernity. Known as the roaring 20's intellectual & cultural hub, Montparnasse is home to many theaters, museums, jazz bars and art galleries. Hit this destination with shopping, culture, food and nightlife.

A tall, lattice-structured tower with a glass-enclosed top section, set against a clear blue sky. The base is partially obscured by green trees.

EIFFEL TOWER

A large, circular neoclassical building with a prominent dome and a portico with columns. The dome is dark green, and the facade is light-colored.

PANTHEON

A tall, modern skyscraper with a glass facade, featuring a green-tinted section near the top. It stands in an urban setting with other buildings and a street below.

MONTPARNASSE TOWER

A grand, classical building with a large dome and a portico with columns. The facade is light-colored, and the dome is dark green. The building is set in a courtyard.

INVALIDES

A wide river with a boat in the distance. The Eiffel Tower is visible in the background under a hazy sky. In the foreground, the silhouettes of people walking on a bridge are visible.

THE SEINE



PARIS MONTPARNASSE DESTINATION

LIVELY HUB ON THE LEFT BANK | A REINVENTED DISTRICT | EASY ACCESS TO MAIN ATTRACTIONS IN PARIS

PULLMAN PARIS
MONTPARNASSE

LES ATELIERS
Gaîté



Montparnasse train
station



Gaîté



1500 parking spaces

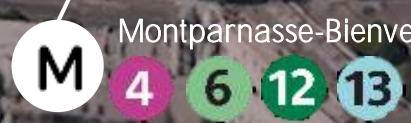

Montparnasse-Bienvenue



8 bus lines



LES ATELIERS GAITÉ

A REINVENTED
DISTRICT



Renovated train station

SHOPPING MALL



+ 60 shops

FOOD COURT



+ 30 restaurants

WOJO: COWORKING,
OFFICE & MEETING



13,000 sq m (139,930 sq ft)

SUMMARY



NEW PULLMAN FLAGSHIP

pullman HOTELS



PULLMAN PARIS MONTPARNASSE

4 YEARS OF TRANSFORMATION, AN INNOVATIVE CONCEPT
THIS IS THE NEW FLAGSHIP OF THE PULLMAN BRAND.



WELCOME

2 lobbies
Group desk
Salon ALL – Elite & VIPs



SLEEP

957 rooms
469 twin rooms
Panoramic views
Stylish & connected rooms



MEET

3 events & banqueting floors
Daylight
Large modular Ballroom
Grand terrace



EAT

5 restaurants & bars
Concepts from US
3 atmospheres
High in the cloud rooftop



PLAY

Pullman Power Fitness
Immersive art areas

PULLMAN NEW GENERATION

PIONEER

OPEN-MINDED

EFFECTIVE

BALANCING WELLBEING & PERFORMANCE



PULLMAN PARIS MONTPARNASSE

WELCOME

A NEW ENTRANCE

GRAND TERRACE

CONFERENCE FACILITIES

LOBBY & RESTAURANTS

HOTEL
ENTRANCE

SUMMARY



ENTRANCE



ENTRANCE

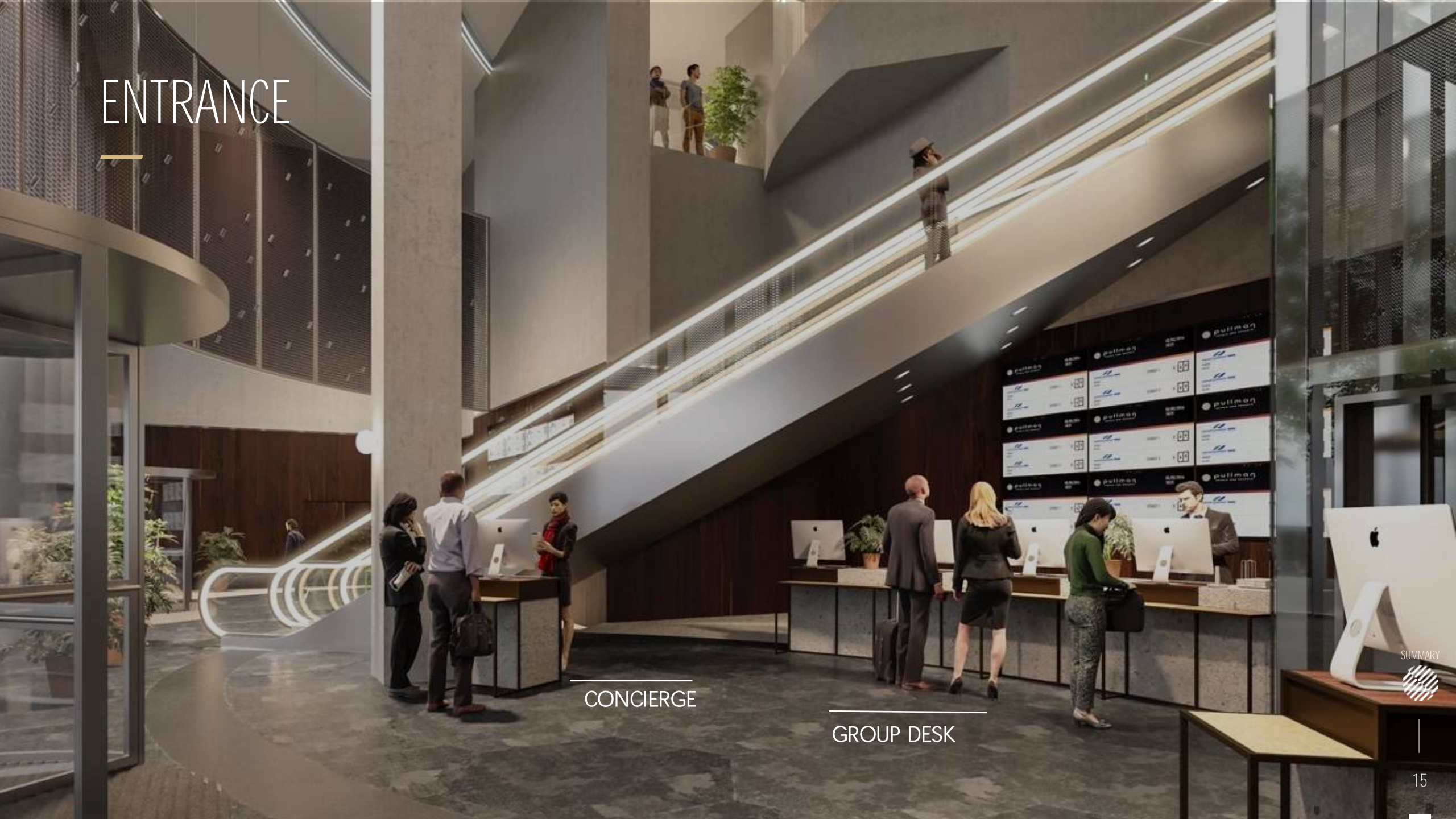

CONCIERGE

GROUP DESK



GRAND LOBBY

CONFERENCE
FACILITIES

FRONT DESK

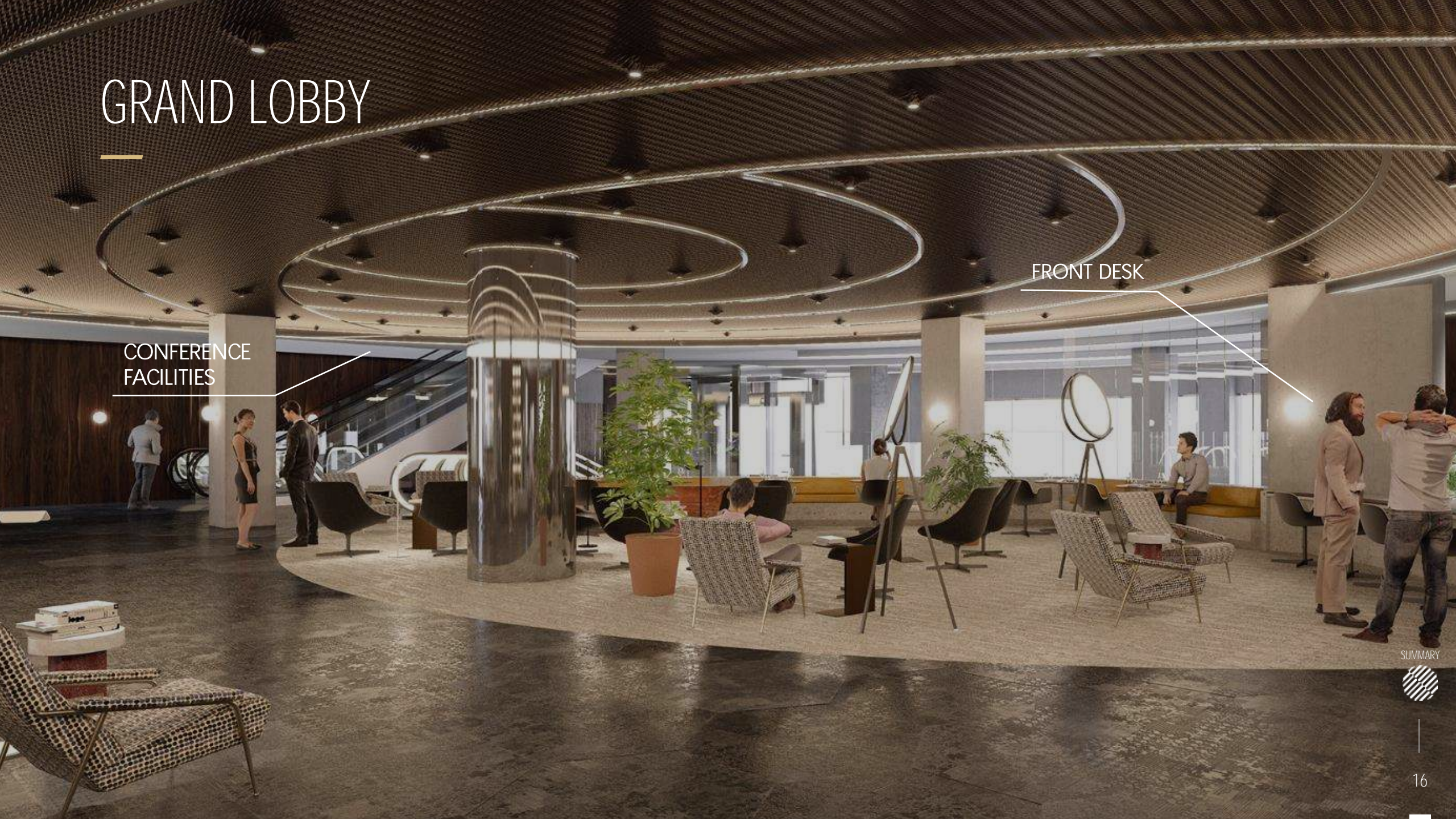

GRAND LOBBY

A'lia BAR & RESTAURANT



FRONT DESK

GRAB & GO

CONFERENCE CENTER

SALON **All** ACCOMMODATE LIFE LIFESTYLE
ELITES & VIPS



LEVEL 2



SALON ALL – ELITE & VIPS

AUGMENTED HOSPITALITY | EXCLUSIVE AND PERSONNALIZED WELCOMING | GUEST SERVICES

Lounge dedicated to ELITE members of the ALL loyalty program and other VIPs. A place of welcome, relaxation and work for our privileged customers.





EAT



EAT

MUST-HAVE FAVORITES

Whether you're looking for an enjoyable casual dining experience, a new favorite happy hour spot, or unique event catering, we will positively surprise your taste buds with burgers... & more.

280 people





EAT

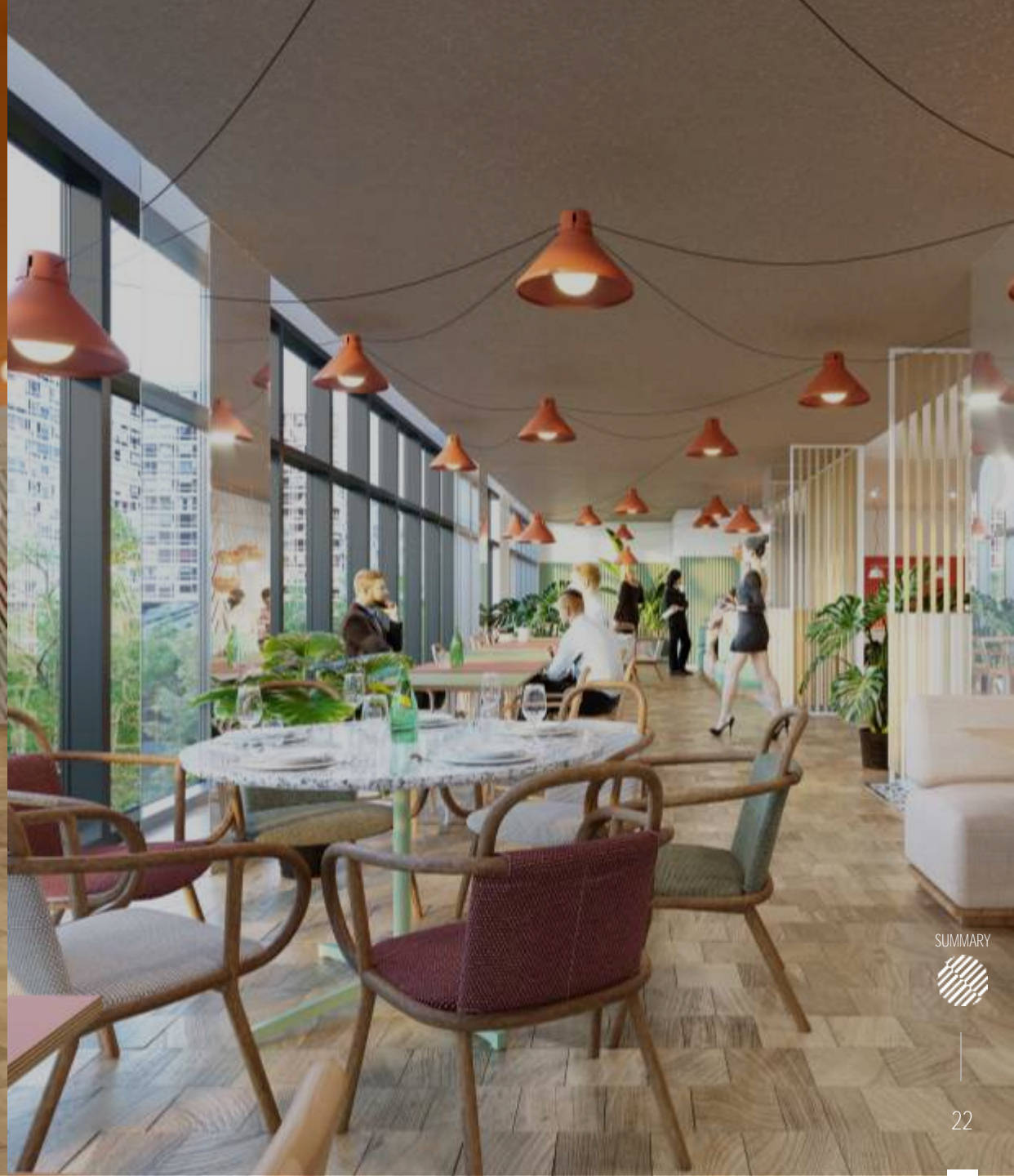



Fil'ia

PARIS

EAT

HONEST ITALIAN FOOD

Fil'ia celebrates hearty and authentic homemade Italian food & drinks. Our unpretentious yet beautiful cuisine will bring your best memories back & create new ones.

OPENING IN 2022

91 people

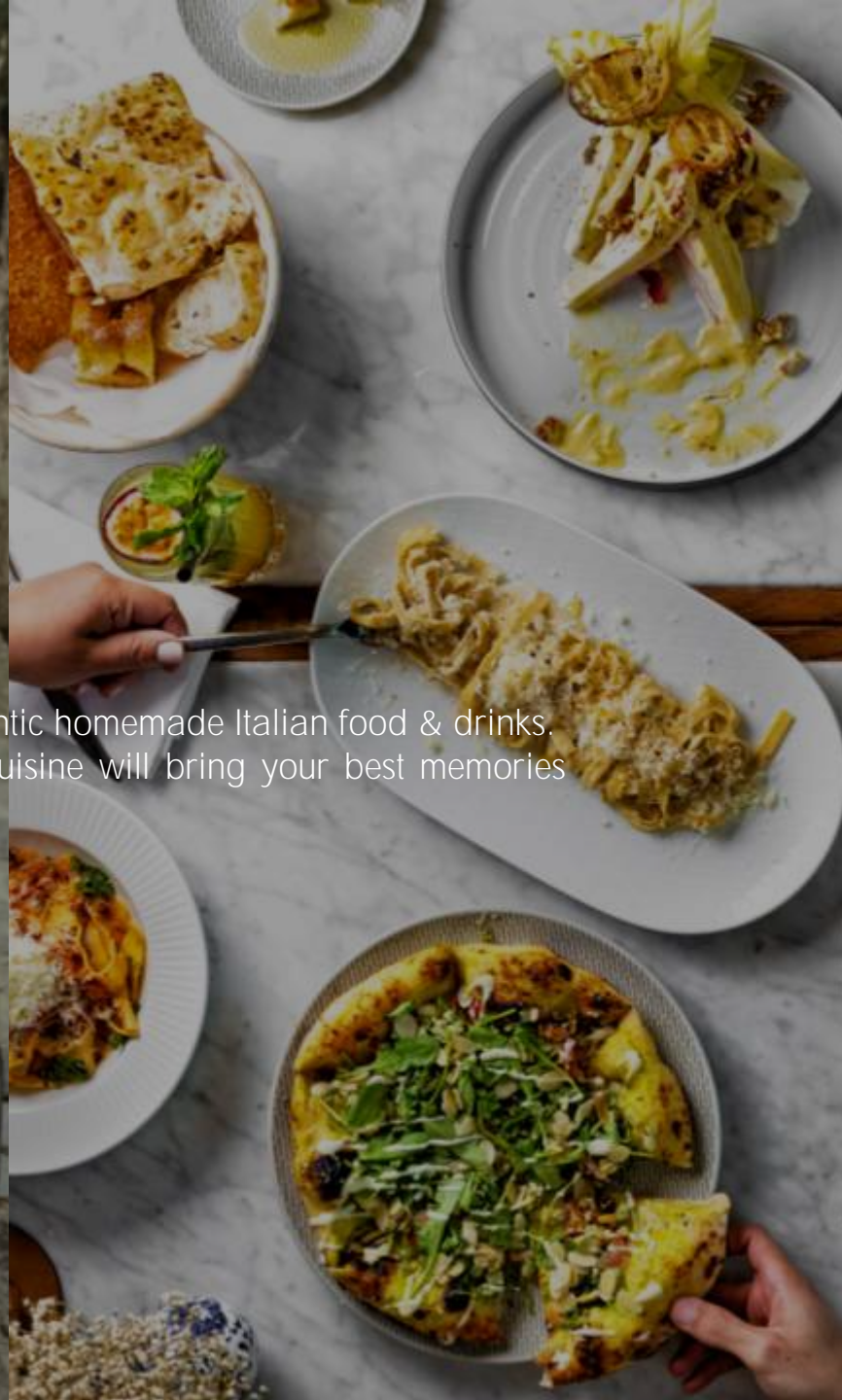

SUMMARY





Filia

PARIS

EAT

THE NEW BEST ITALIAN RESTAURANT

Crusty loafs, handmade pasta, antipasti to share (or not!).

OPENING IN 2022



Filia

PARIS

DRINK

APERITIVO TIME

Cocktails are refreshingly uncomplicated – less about complex recipes & technique, and more about how perfect a Spritz is on a July or December afternoon.

OPENING IN 2022



SLEEP

SLEEP

STYLISH | DESIGN

Press the pause button in one of the 957 rooms, suites or apartments located above the buzz of the city from the 8th to 32nd floor.

Modern, elegant, connected... Suspended between earth & sky...!

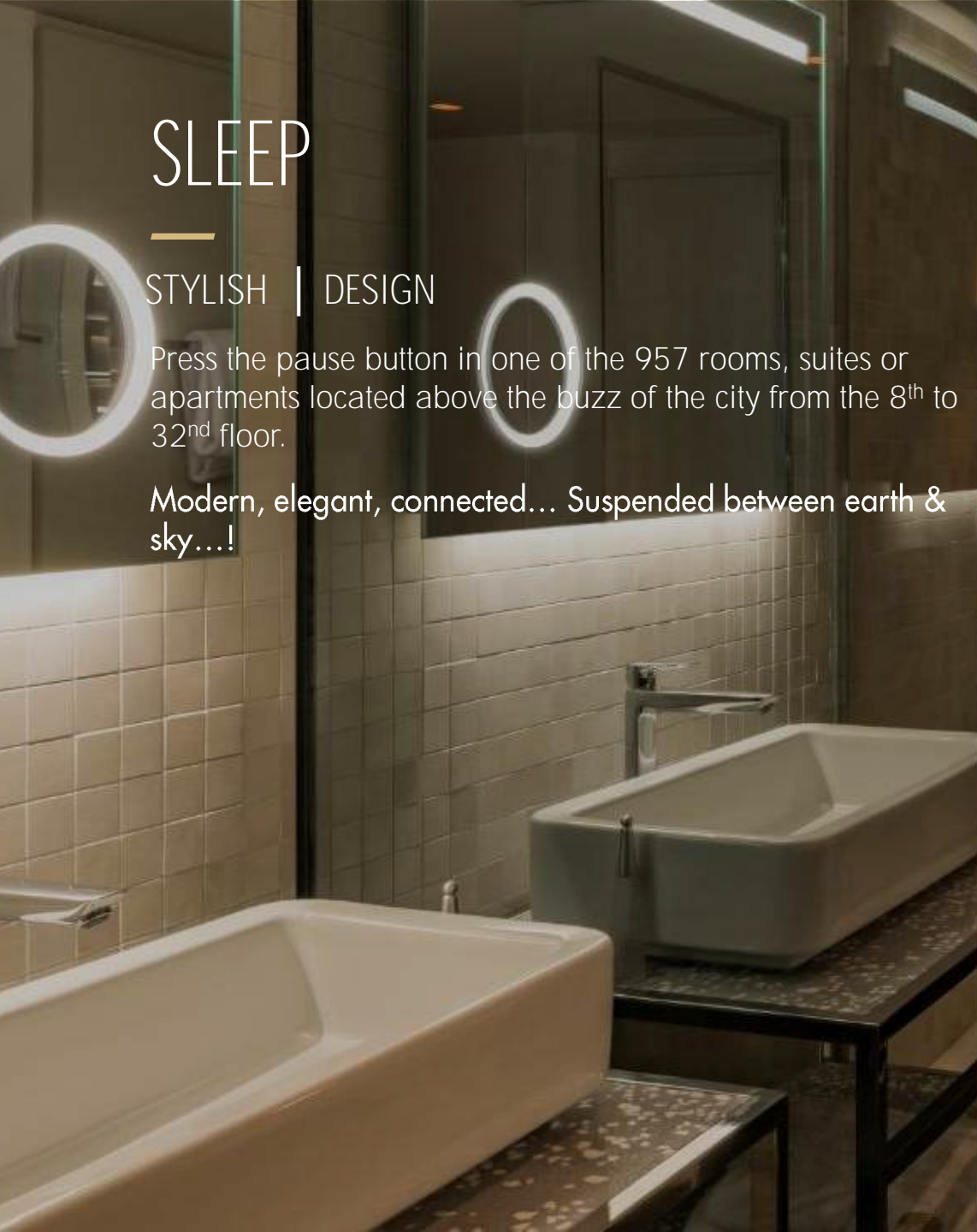

SLEEP

322 CLASSIC



From 25 sq m (269 sq ft)
8th to 17th floor
1 queen-size bed or 2 single beds
Bathtub

332 DELUXE



25 sq m (269 sq ft)
18th to 32nd floor
1 queen-size bed or 2 single beds
Rain shower
Paris view

40 DELUXE EXECUTIVE



30 sq m (323 sq ft)
18th to 32nd floor
1 king-size bed
Rain shower
Paris view

120 DELUXE PREMIUM



25 sq m (269 sq ft)
18th to 32nd floor
1 king-size bed or 2 single beds
Rain shower
Paris & Sacré-Coeur view

128 FAMILY



30 sq m (323 sq ft)
8th to 32nd floor
2 queen-size beds
Bathtub or rain shower

11 SUITES



60 sq m (645 sq ft)
22nd to 32nd floor
1 king-size bed
Living-room with 1 sofa bed
2 bathrooms:
bathtub and rain shower

4 APARTMENTS



From 47 to 60 sq m (505-645 sq ft)
29th to 32nd floor
1 king-size or queen-size bed
Living room with 1 Sofa bed
Rain shower
Fully equipped kitchenette



MEET

MEET

WORK | PLAY

Spread over 3 dedicated floors, our conference facilities includes daylight state-of-the-art meeting & banqueting rooms. Limitless offer for creative brains.

Ideal meet, eat, sleep: 400-650 delegates

EVENT CENTER – BALLROOM & STUDIOS

- 742 sq m (7,987 sq ft) modular ballroom | 7m high
- 800 sq m (8,611 sq ft) of grand terrace
- 1 executive room with private dining facilities & private terrace
- 19 modular guestrooms
- À la carte catering

EVENT CENTER – GREEN FLOOR

COMING SOON (FROM SEPTEMBER 2022)...

- 1 additional floor: C2 space

EVENT CENTER – C2 SPACE

EVENT CENTER

BALLROOM & STUDIOS



EVENT CENTER

BALLROOM & STUDIOS

ROOMS	SURFACE (SQM)	HEIGHT (M)	 THEATER	 CLASSROOM	 U-SHAPE	 BOARD	 CABARET	 BANQUET ROUNDS	 SEATED BUFFET	 COCKTAIL
LEVEL III - EVENT CENTER BALLROOM & STUDIOS										
Grand Ballroom	742	7	726	336	-	-	308	624	504	715
Ballroom 1	248	7	192	96	-	-	98	192	156	220
Ballroom 2	107	7	108	40	-	-	56	96	72	105
Ballroom 3	216	7	192	96	-	-	98	192	156	200
Ballroom 4	171	7	144	64	-	-	77	144	108	160
Ballroom 1-2	355	7	315	175	-	-	161	300	264	320
Ballroom 1-2-3	571	7	529	256	-	-	224	480	408	530
Ballroom 2-3	323	7	310	160	-	-	140	288	240	305
Ballroom 2-3-4	494	7	473	240	-	-	224	432	360	470
Ballroom 3-4	387	7	374	192	-	-	189	324	288	360
Foyer Grand Ballroom	450	-	-	-	-	-	-	-	-	370
Studios	326	3	-	-	-	-	98	240	240	276
Studio 1 to 5	from 54	3	42	18	16	20	28	48	48	60
Studio 1-2	121	3	88	32	-	-	56	96	96	110
Studio 1-2-3	188	3	136	48	-	-	84	144	144	170
Studio 1-2-3-4	256	3	-	-	-	-	91	192	192	220
Studio 2-3	134	3	88	32	-	-	56	96	96	110
Studio 2-3-4	202	3	136	48	-	-	84	144	144	170
Studio 2-3-4-5	272	3	-	-	-	-	91	192	192	220
Studio 3-4	135	3	88	32	-	-	56	96	96	110
Studio 3-4-5	205	3	136	-	-	-	84	144	144	170
Studio 4-5	135	3	88	32	-	-	56	96	96	110
Foyer Studios	190	2,5	-	-	-	-	-	-	-	120
Grand Studios (= Studios + Foyer Studios)	516	2,5 - 3	-	-	-	-	-	336	300	390
Foyer Grand Ballroom + Grand Studios	966	-	-	-	-	-	-	-	-	850



EVENT CENTER

GREEN FLOOR



EVENT CENTER

GREEN FLOOR: GRAND TERRACE

URBAN GARDEN

800 sq m (8,611 sq ft)

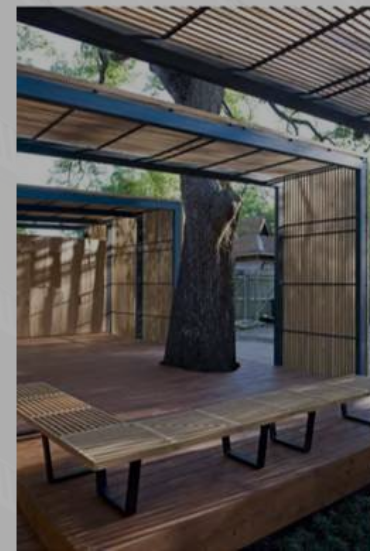









SOMMAIRE



EVENT CENTER

GREEN FLOOR

ROOMS	SURFACE (SQM)	HEIGHT (M)	 THEATER	 CLASSROOM	 U-SHAPE	 BOARD	 CABARET	 BANQUET ROUNDS	 SEATED BUFFET	 COCKTAIL
LEVEL IV - EVENT CENTER GREEN FLOOR										
Green Suite 1	96	2,80	60	32	26	28	32	50	50	70
Green Suite 2	39	2,80	25	-	-	14	-	-	-	-
Green Room 1	32	2,80	25	12	12	14	12	-	-	-
Green Room 2	45	2,80	35	18	18	20	18	-	-	-
Green Room 3	32	2,80	25	12	12	14	12	-	-	-
Green Room 4	53	2,80	48	22	20	24	22	40	40	50
Green Room 5	53	2,80	48	22	20	24	22	40	40	50
Green Room 6	55	2,80	48	22	20	24	22	40	40	50
Green Room 7	58	2,80	48	22	20	24	22	40	40	50
Green Room 8	40	2,80	30	16	16	18	16	-	-	-
Green Room 9	32	2,80	25	12	12	14	12	-	-	-
Green Room 10	68	2,80	54	24	22	26	24	40	40	54
Green Room 11	66	2,80	54	24	22	26	24	40	40	54
Green Room 12	35	2,80	25	12	12	14	12	-	-	-
Green Room 13	32	2,80	25	12	12	14	12	-	-	-
Grand Terrace	800	-	-	-	-	-	-	-	-	-



EVENT CENTER

C2 SPACE

IMMERSIVE EVENTS | ART & TECHNOLOGY | 1,500 SQ M (16,145 SQ FT) MODULAR

OPENING SEPTEMBER 2022



US YOU'RE THE NAME WE'RE LIFTING HIGH
GLORY SHAKING UP THE EARTH AND SKIES

ING JESUS YOU'RE THE NAME WE'RE LIFTING HIGH
GLORY SHAKING UP THE EARTH AND SKIES

PLAY

PULLMAN POWER FITNESS

200 SQ M (2,153 SQ FT) OF NEW GENERATION FITNESS ROOM

OPEN 24/7



CARDIO



STRENGTH



STRETCHING

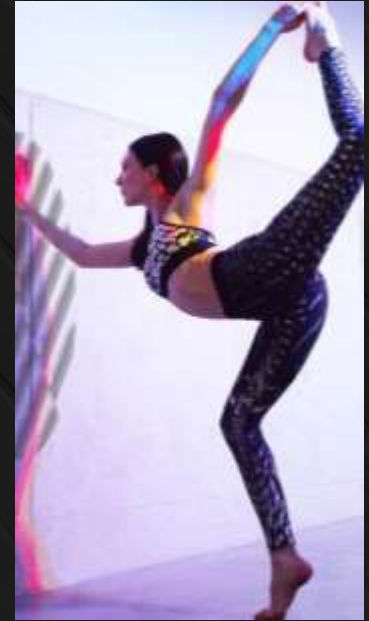



ARTIST PLAYGROUND

INSPIRING MINDS THROUGH ART

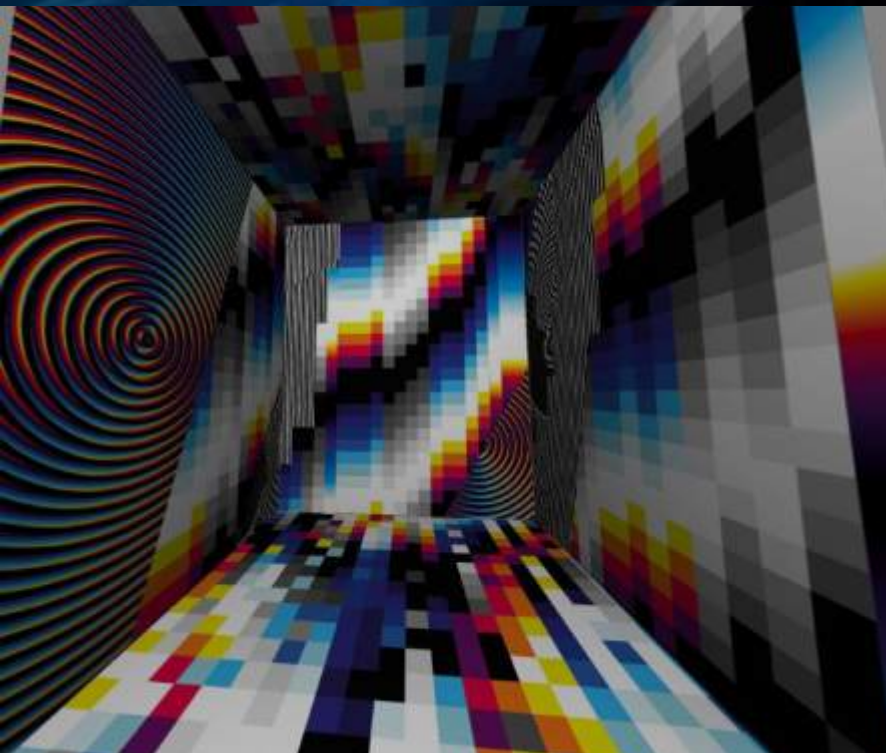

ARTIST
PLAYGROUND



DREAM

DREAM

Perched at a height of 115m with spectacular views of Paris, **Skybar Paris** is the trendiest rooftop of the capital. Its captivating energy will take you from sunset to starry night.

46 SEATS INSIDE & 52 SEATS OUTSIDE

ELEGANT & GLAMOUROUS



ONE IN A LIFETIME EXPERIENCE



URBAN CHIC STYLE



ROOFTOP BAR





SKYBAR
PARIS

DREAM

With DJs, innovative cocktails & Asian lite bites, Skybar Paris matches any mood at any time!





S K Y B A R

P A R I S

DREAM

LIVE THE HIGHLIFE

Make an already special event, extraordinary -
Book our exclusive outdoor VIP area with its
dedicated bartender & the best view of the city.



ARE YOU READY TO RISE?

CONTACT US

LEILA SALHI — DIRECTOR OF SALES

leila.salhi@accor.com

Tel: +33 (0)6 99 63 05 79

LAURA MATVEIEFF — DEPUTY DIRECTOR OF SALES

laura.matveieff@accor.com

Tel: +33 (0)6 24 96 38 44

MEETINGS & EVENTS

pullman.meetings.paris@accor.com

Tel: +33 (0)1 46 62 45 22
